

Z83/...

Mat.: 2.0401



► Info

Z80/...  
Z801/...  
Z807/...  
Z82/...

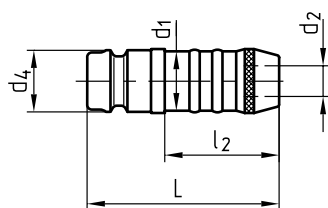

Z85/...  
Z851/...  
Z853/...  
Z854/...

Typ A

Typ B

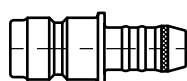

$l_2$	L	$d_2$	Typ	$d_4$	$d_1$	Nr./No.
22,5	43,5	6	A	<b>9</b>	<b>9</b>	Z83/ 9
25	42	9		<b>13</b>	<b>13</b>	13
32	61	13		<b>19</b>	<b>19</b>	19
22,5	39,5	6	B	<b>13</b>	<b>9</b>	13/ 9
25	54	9		<b>19</b>	<b>13</b>	19/13

Z831/...

Mat.: 2.0401



► Info

Z80/...  
Z801/...  
Z807/...  
Z82/...

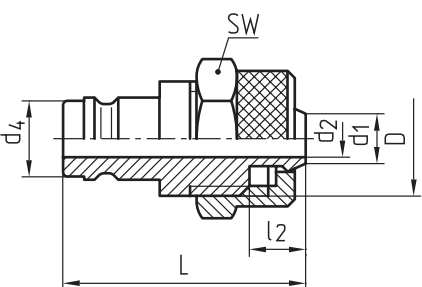

◀ Z84/...

Druckluft  
Air pressure  
Air comprimé

SW	D	$l_2$	L	$d_2$	$d_4$	$d_1$	Nr./No.
14	M12x1	6	32	5	9	6	Z831/9/6

This is trial version  
www.adultpdf.com